



PART OF TOWNSHIP 51 N. &  
FRAC. TOWNSHIP 50 N. RANGE 33 W.

OF THE 5<sup>TH</sup> P. M.

Scale 2 inches to 1 mile

**PARKVILLE**

TWP 51 N. R 34 W.  
Scale 400 feet to one inch.

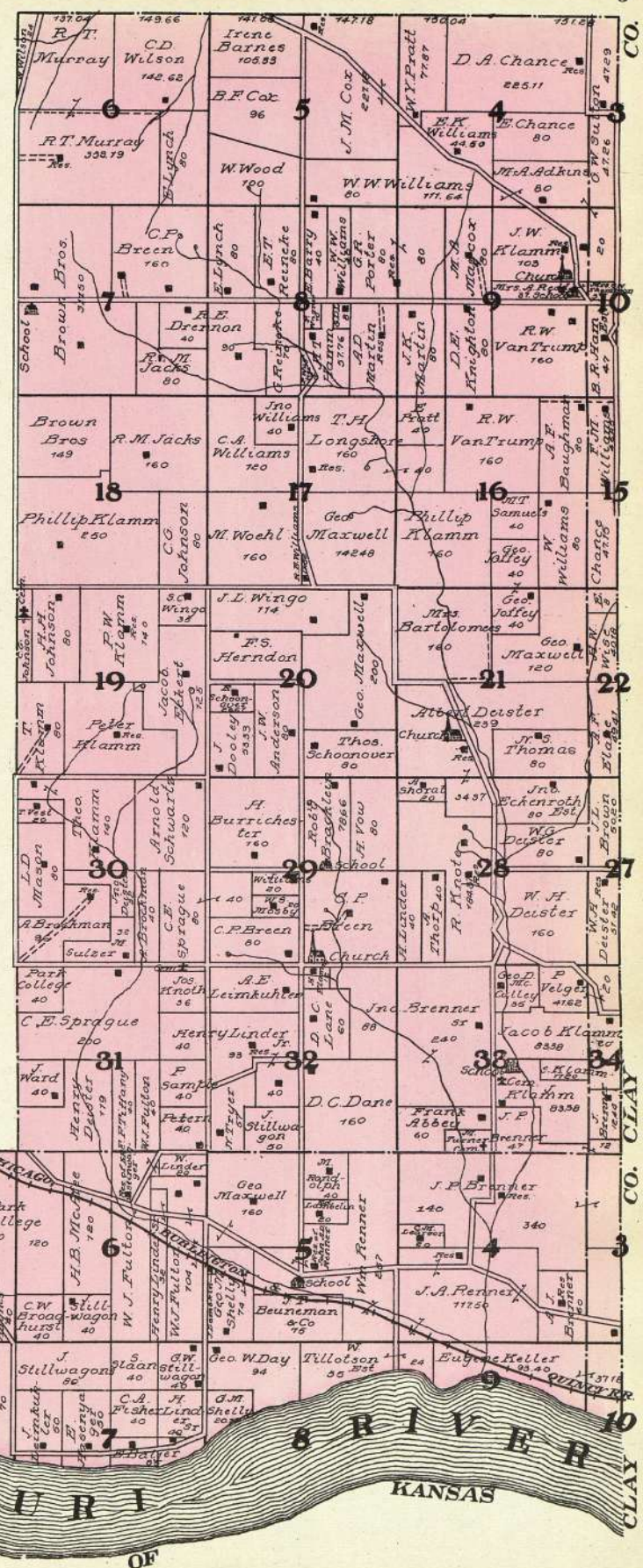
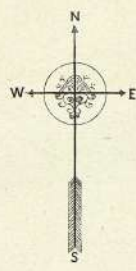
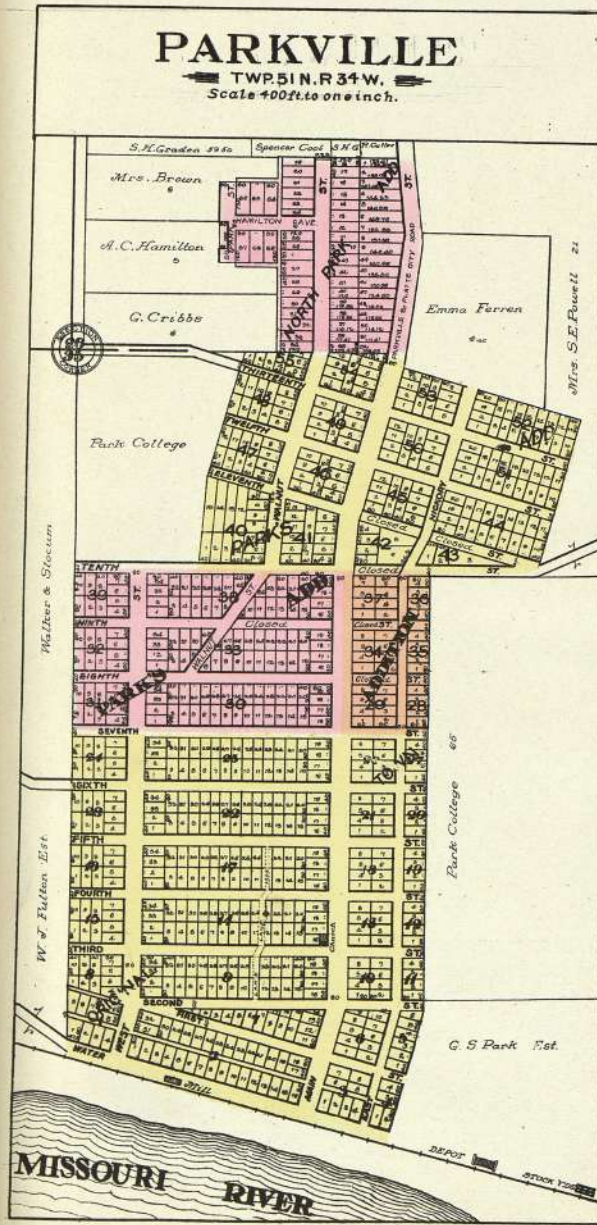



  
 MAP OF  
 FRAG. TOWNSHIP 51 N RANGE 35 W  
Scale 2 inches to 1 Mile

OF THE 5<sup>TH</sup> P. M.





  
**MAP OF**  
**TOWNSHIP 52 N RANGE 34 W**  
Scale 2 Inches to 1 Mile

OF THE 5TH P. M.

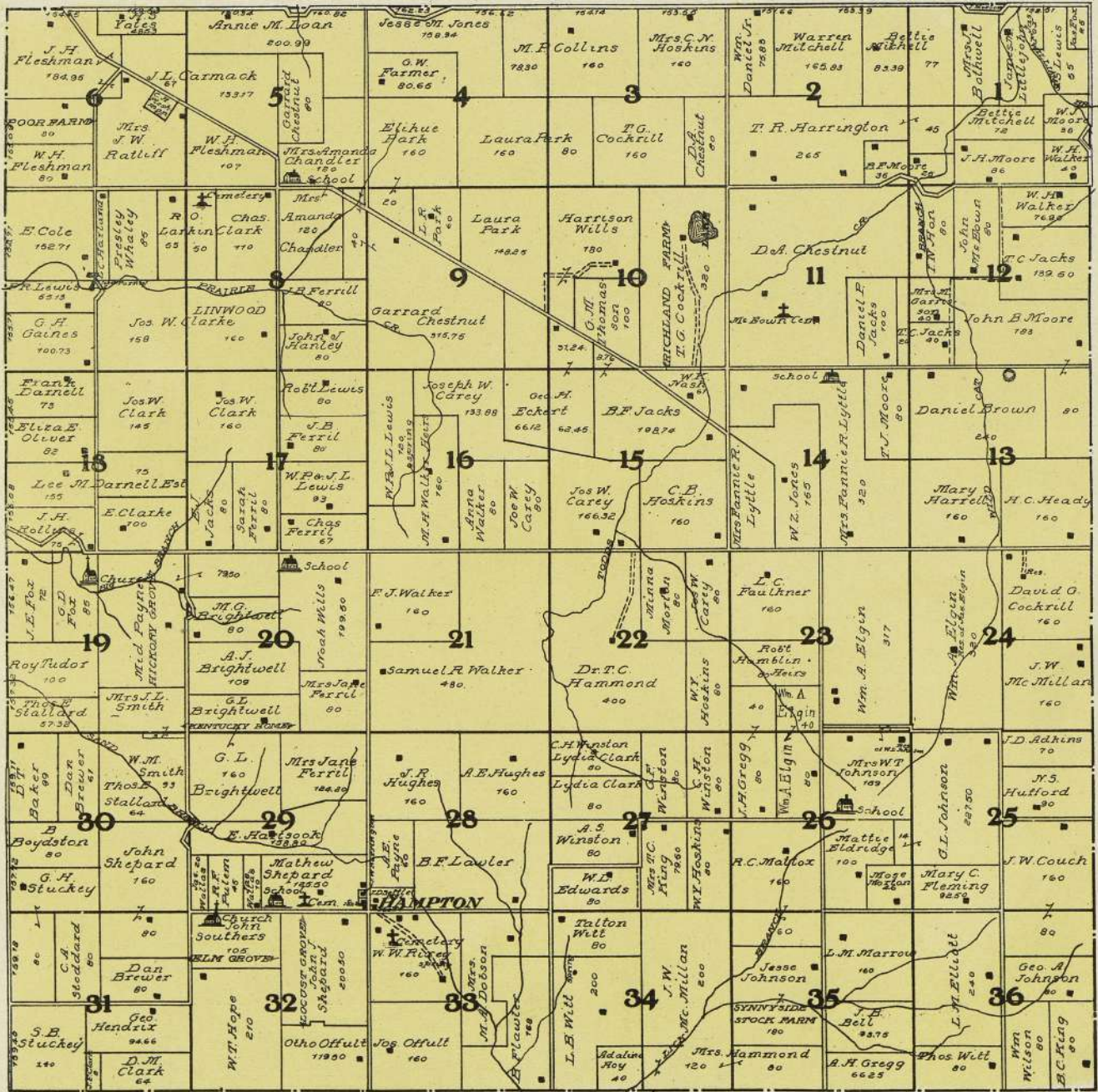

# WESTON

TWP. 53 N. R. 36 W.

Scale: 400 ft. to one inch.

George Brill  
66 1/2

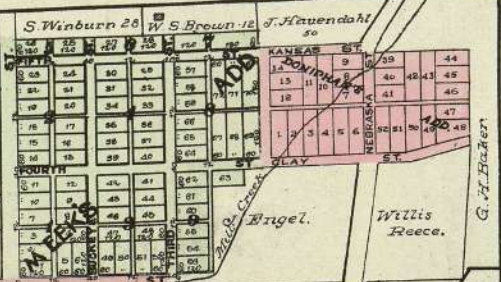

# MISSOURI RIVER

STATE MISSOURI OF

LEAVENWORTH ISLAND

A. Whistley 224 90

St. E. Wells.

F. Blacketer  
S. Siler

St. E. Wells.

Cox & Thorn.

Cox & Thorn.

Post Leavenworth  
Unit  
2 Miles

CHICAGO





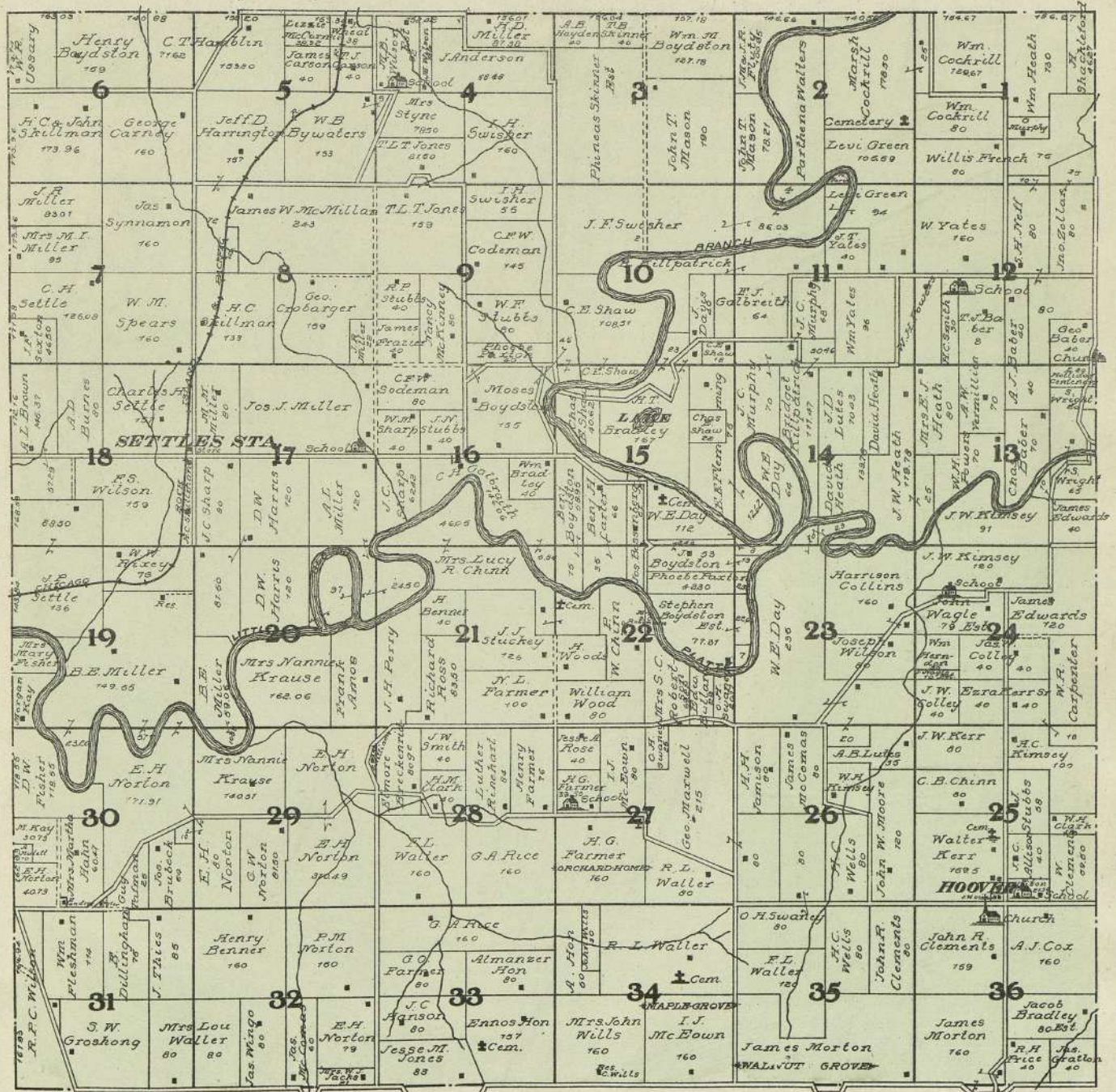

**MAP OF**  
**TOWNSHIP 53 N RANGE 34 W**  
Scale 2 inches to 1 Mile

OF THE 5<sup>TH</sup> P. M.



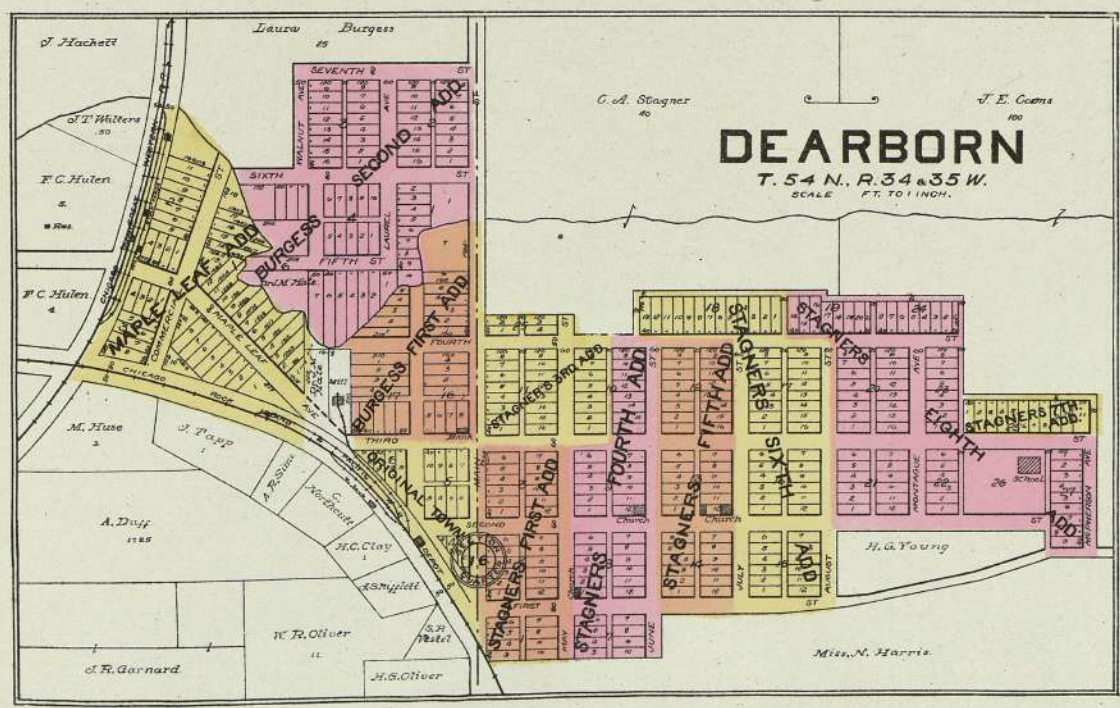
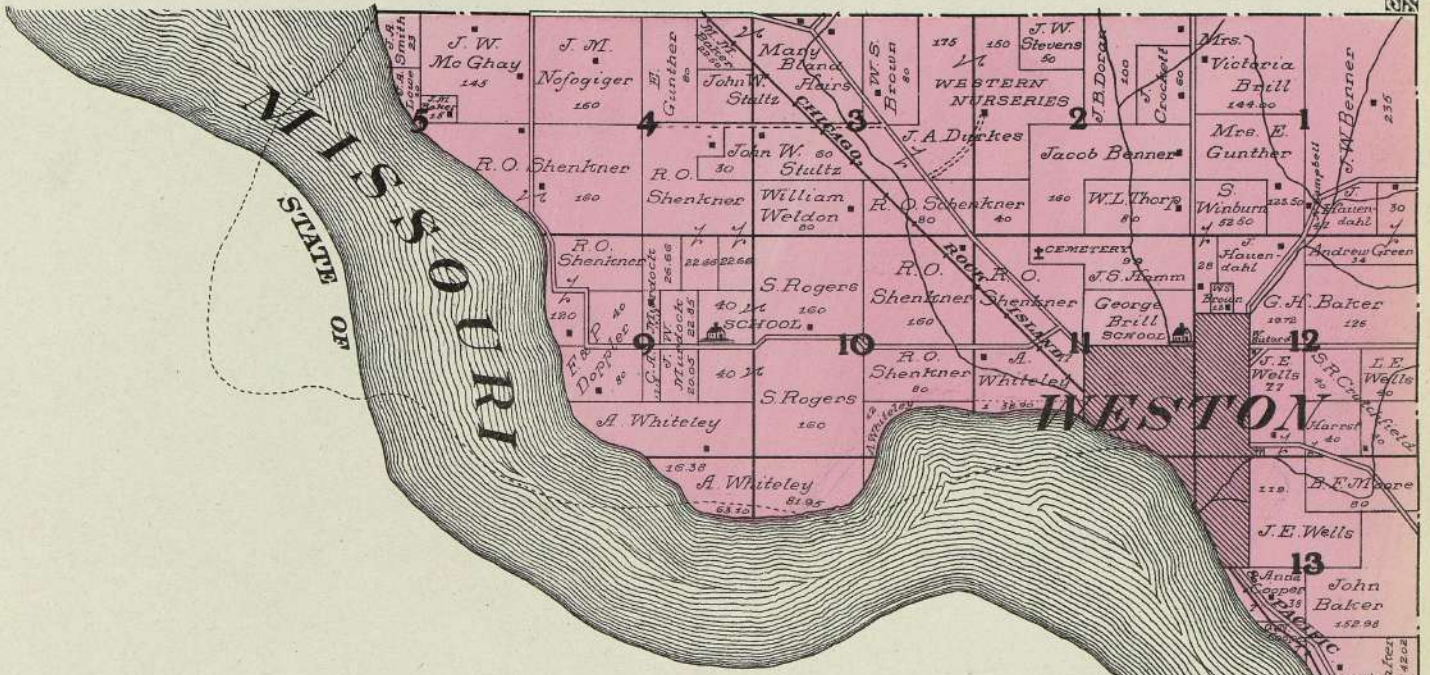

MAP OF  
 FRAC. TOWNSHIP 53 N RANGE 36 W  
 OF THE 5<sup>TH</sup> P. M.



PART OF  
**TOWNSHIP 54-55 N RANGE 33 W**  
Scale 1/2 inch to 1 Mile

OF THE 5<sup>TH</sup> P. M.

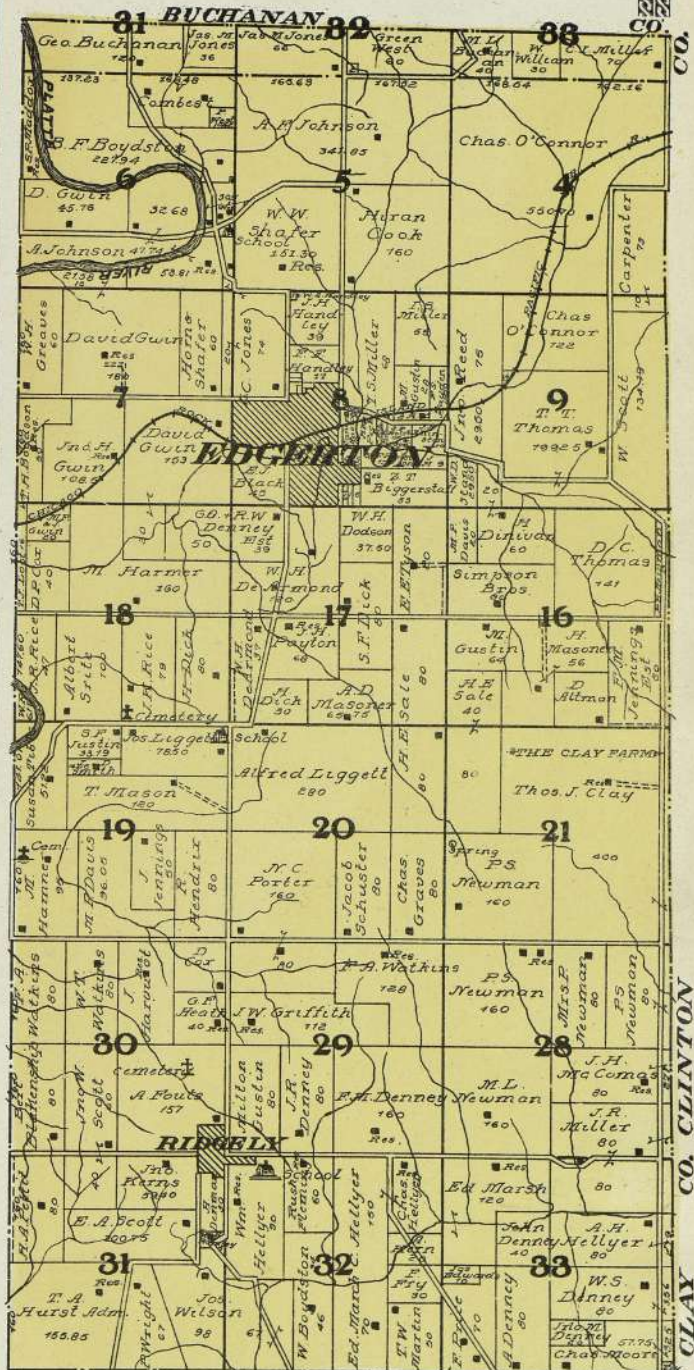
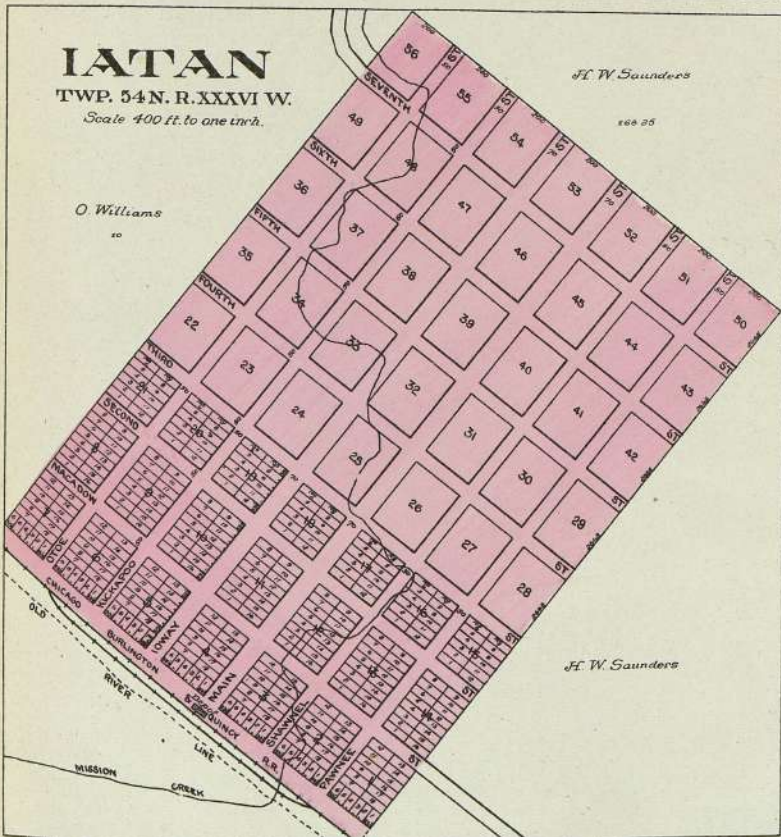
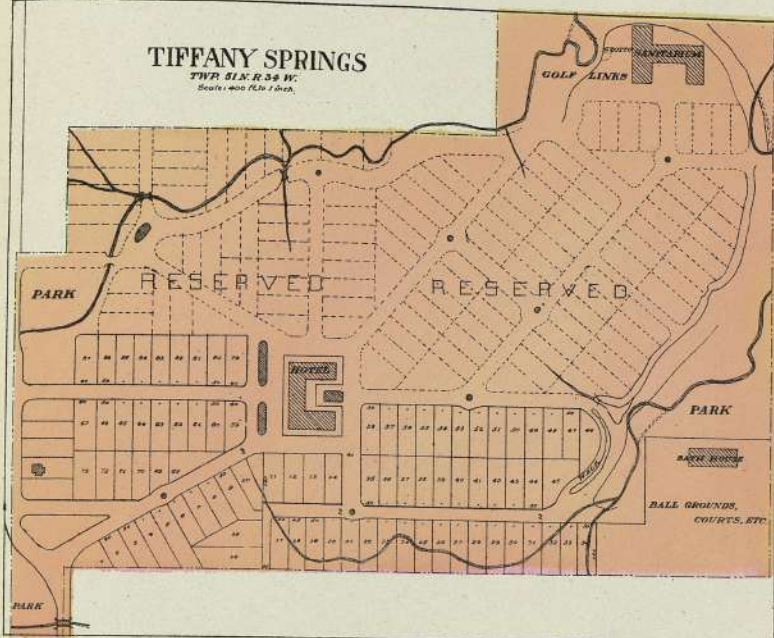



  
**MAP OF**
  
 TOWNSHIP 54 N. PART OF TOWNSHIP 55 N. RANGE 34 W.

Scale 2 inches to 1 Mile

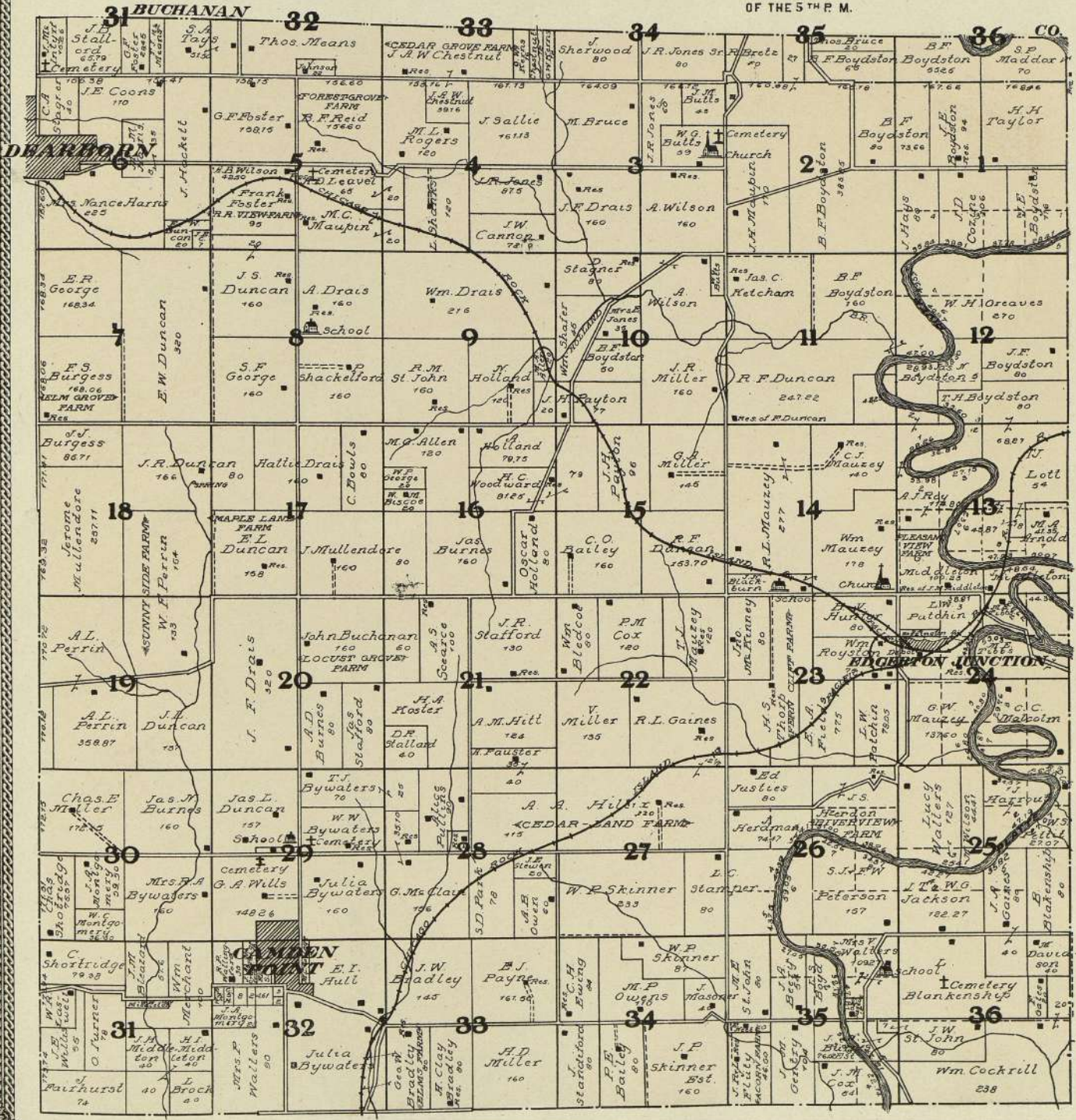
OF THE 3<sup>RD</sup> P. M.

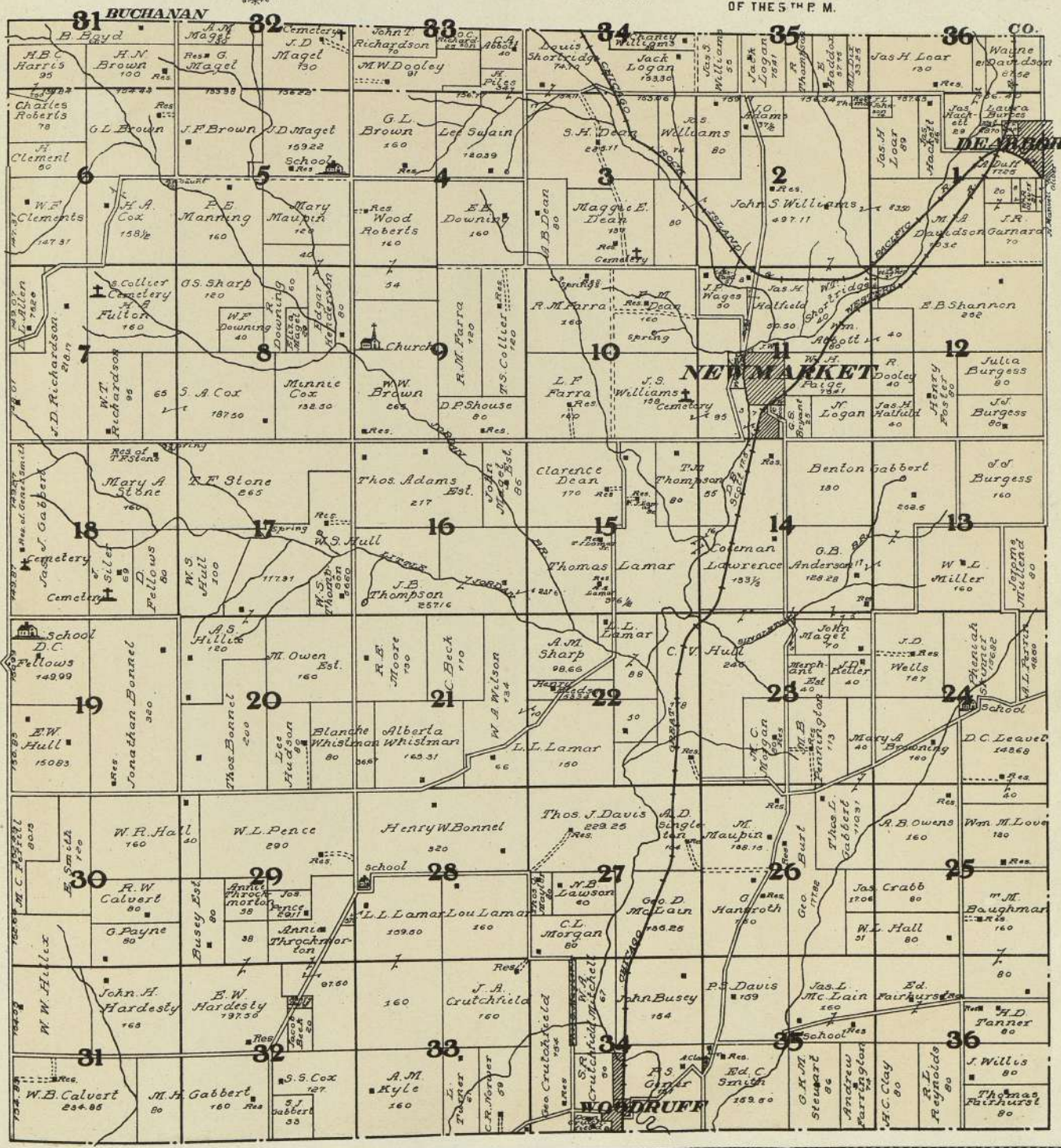

MAP OF  
TOWNSHIP 54 N. PART OF TOWNSHIP 55 N. RANGE 35 W.  
OF THE 1<sup>ST</sup> P. M.



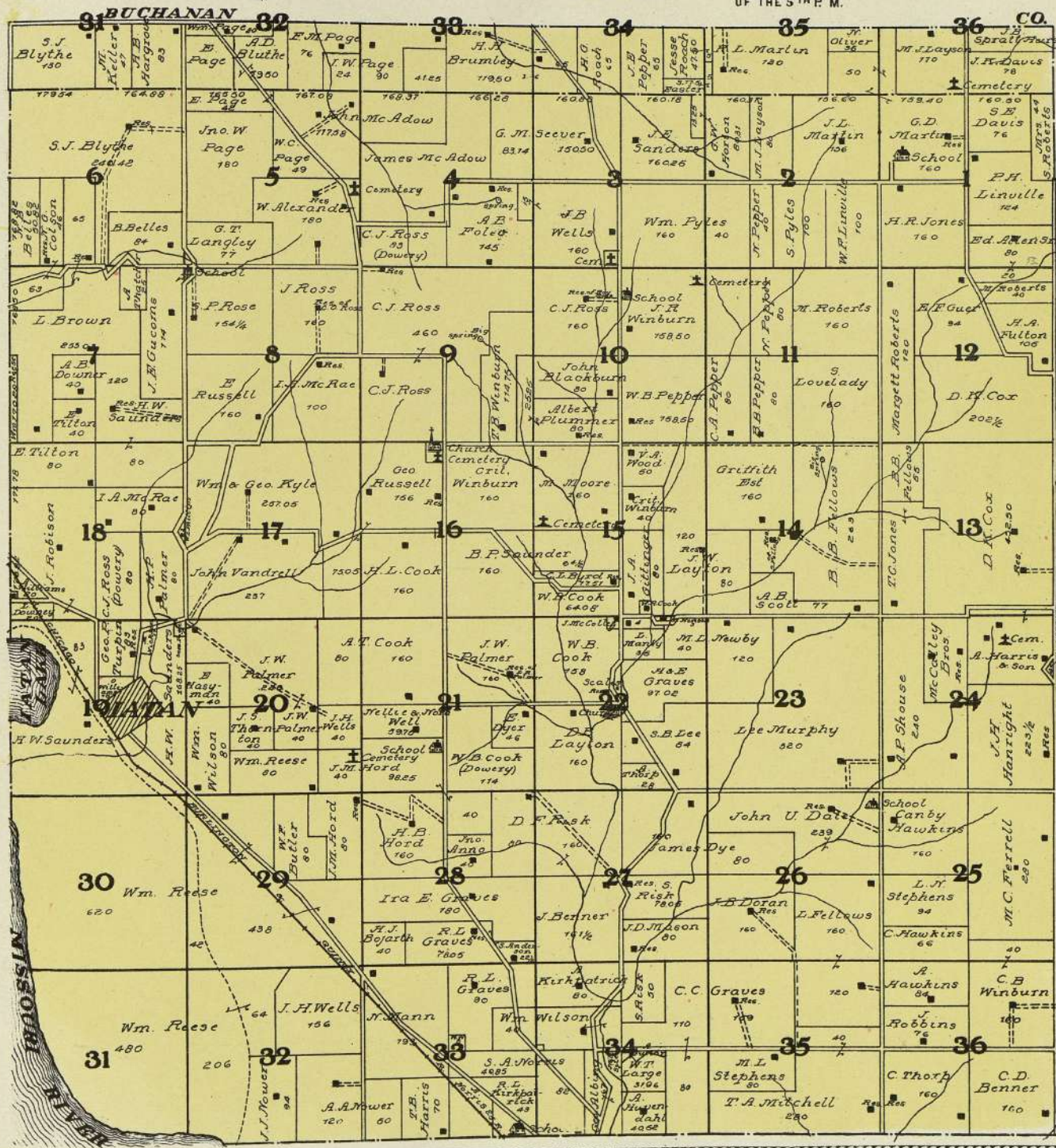

  
 MAP OF  
 FRAC. TOWNSHIP 54 N. & PART OF TOWNSHIP 55 N. RANGE 36 W.  
 OF THE 3<sup>RD</sup> P. M.  
Scale 1 inch to 1 mile



MISSOURI RIVER

**MAP OF**  
 FRAC. TOWNSHIP 54 N. & PART OF FRAC. TOWNSHIP 55 N. RANGE 37 W.  
Don L. Litchner & P. H. H.

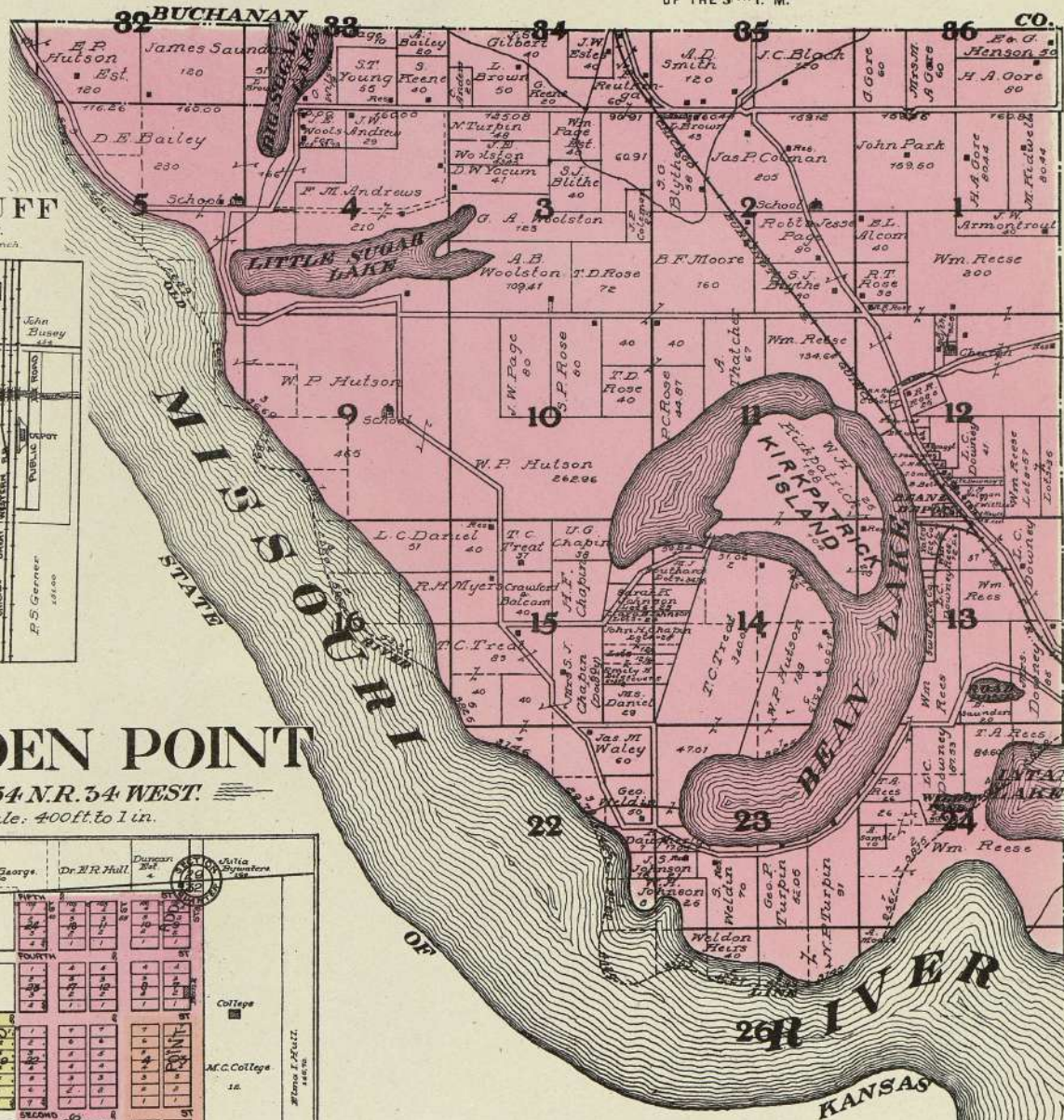
OF THE 5<sup>TH</sup> P. M.



**WOODRUFF**  
 TWP. 54 N. R. 35 W.  
 Scale - 400 ft. to 1 in.

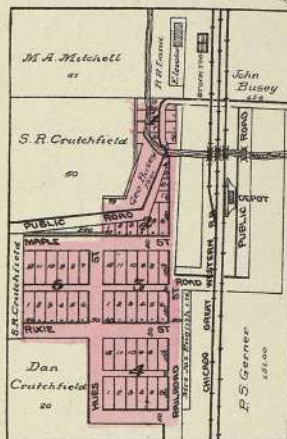

**CAMDEN POINT**  
 TWP. 54 N. R. 34 WEST.  
 Scale: 400 ft. to 1 in.

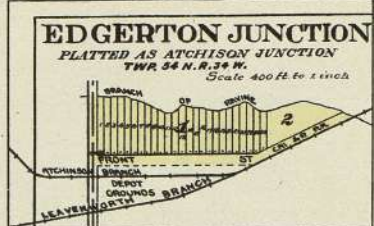
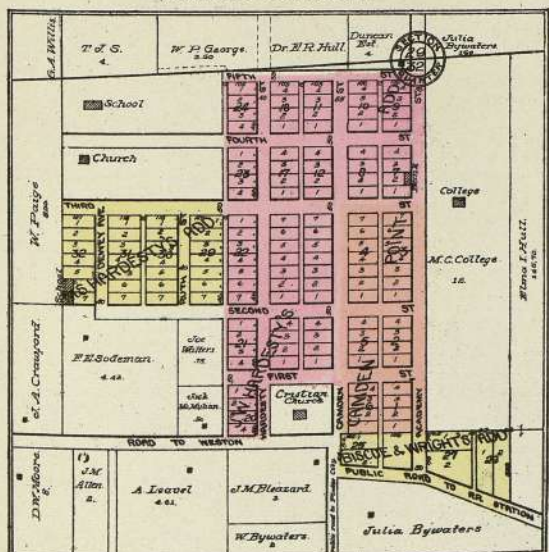

**PLATTE CITY**  
 COUNTY SEAT OF PLATTE CO.  
 MISSOURI  
 INCLUDING  
**TRACY**

PERSONS  
 Scale 400 Feet to one inch

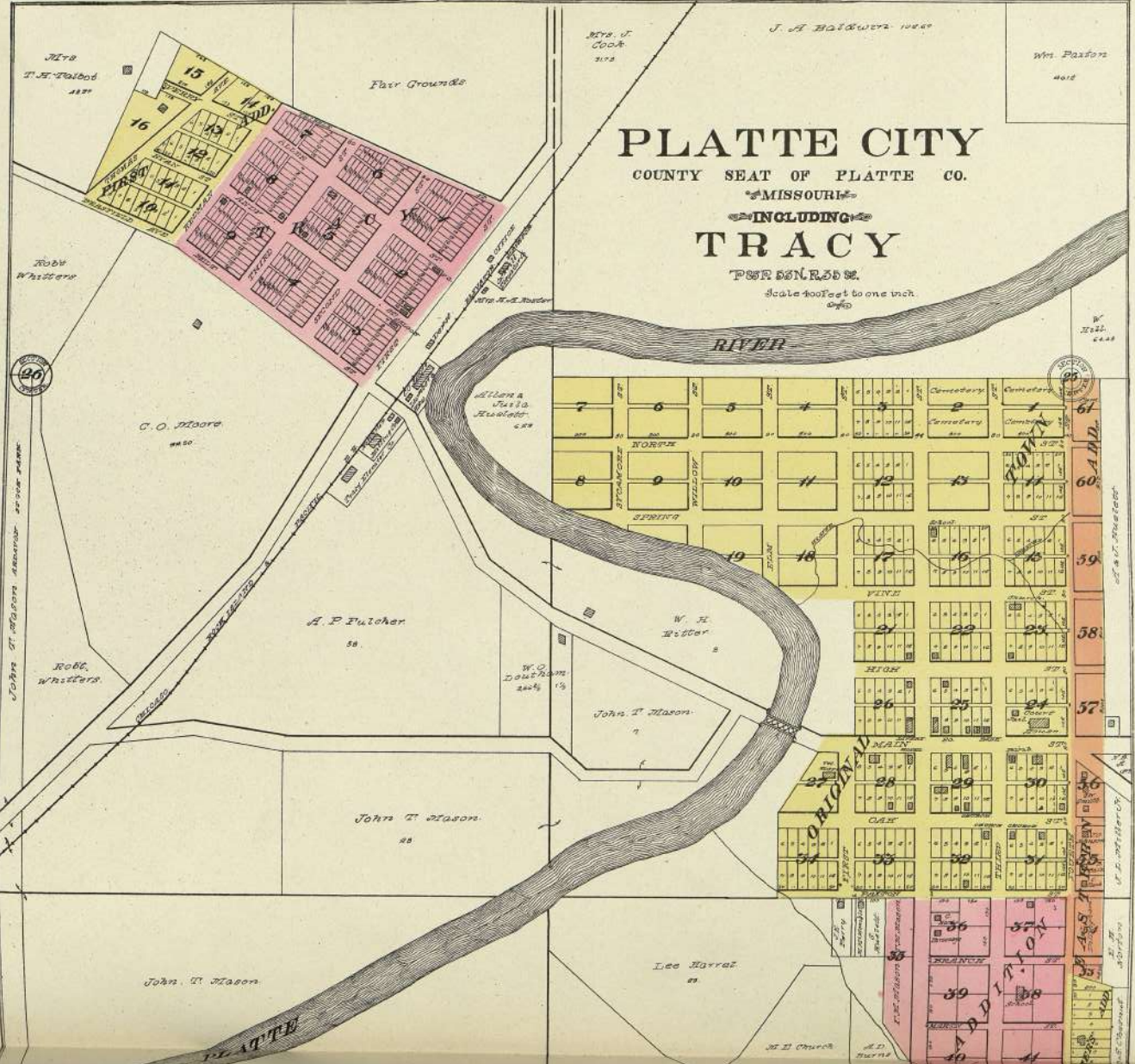

W. Hill 4448

61  
60  
59  
58  
57

56  
55  
54  
53  
52  
51

50  
49  
48  
47  
46  
45  
44  
43  
42  
41  
40  
39  
38  
37  
36  
35  
34  
33  
32  
31  
30  
29  
28  
27  
26  
25  
24  
23  
22  
21  
20  
19  
18  
17  
16  
15  
14  
13  
12  
11  
10  
9  
8  
7  
6  
5  
4  
3  
2  
1

20

20

John T. Mason Assessor - 1878

of W. H. Ritter

U. S. Post Office

U. S. Post Office

